



## TANEY RETIREMENT VILLAGE

Four storey over basement development of retirement accommodation

**Client: Dublin Dockland Development Authority**

### SUMMARY:

**Value:** €35 million

**Architect:** DMO'D Architects

**Status:** Planning

### Services Provided:

Detailed Design

Traffic Impact Assessment

A retirement village in three blocks consisting of apartments, nursing home, sheltered accommodation and specialist facilities.

This community project provides a continuum of care for the older person comprises seventy-two units of independent living in one and two bed apartments, twelve units of assisted living, forty-eight nursing home beds and sixteen units of high dependency care.

The building is constructed over an underground car park with reinforced concrete walls. Nicholas O'Dwyer are responsible for the Traffic Impact Assessment, civil design of the foul and surface water drainage and structural design of the basement and superstructure

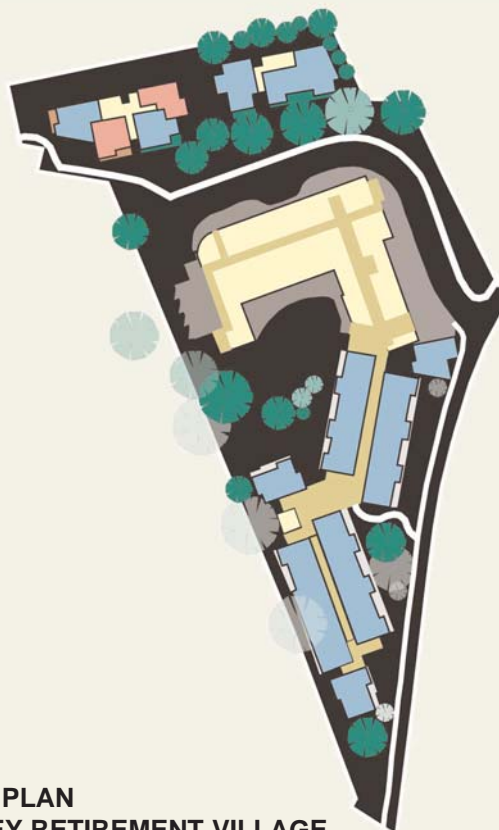

SITE PLAN  
TANEY RETIREMENT VILLAGE



Nicholas O'Dwyer  
CONSULTING ENGINEERS