



EXPANSION OF MJM GROUP HEADQUARTERS, PHASE 2

Construction of warehouse and office accommodation, Newry

Client: MJM Group

SUMMARY:

Value: £3.1 million
Status: Construction of the office lift shafts is almost complete
Architect: Delahunty and Laverty
Main Contractor: MJM Group
Struct/Civil Engineer: Nicholas O'Dwyer Ltd

Accommodation Provided:
55,640 sq. ft. of warehouse accommodation and 22,952 sq.ft. of office accommodation.



Construction of the Concrete lift shafts (Phase 1 in background)

MJM Group is currently in the process of expanding their premises with the construction of 55,640 sq. ft. of warehouse accommodation and 22,952 sq. ft. of office accommodation.

Nicholas O'Dwyer is responsible for the structural and civil design, and also acts as the CDM coordinator. Nicholas O'Dwyer also performed these responsibilities for the Phase 1 project, currently occupied and shown to the right below.

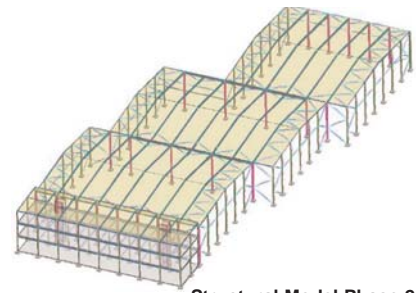

Structural Model Phase 2 Expansion



Phase 2 Expansion shown to the left



Nicholas O'Dwyer
CONSULTING ENGINEERS

